

Part #17478

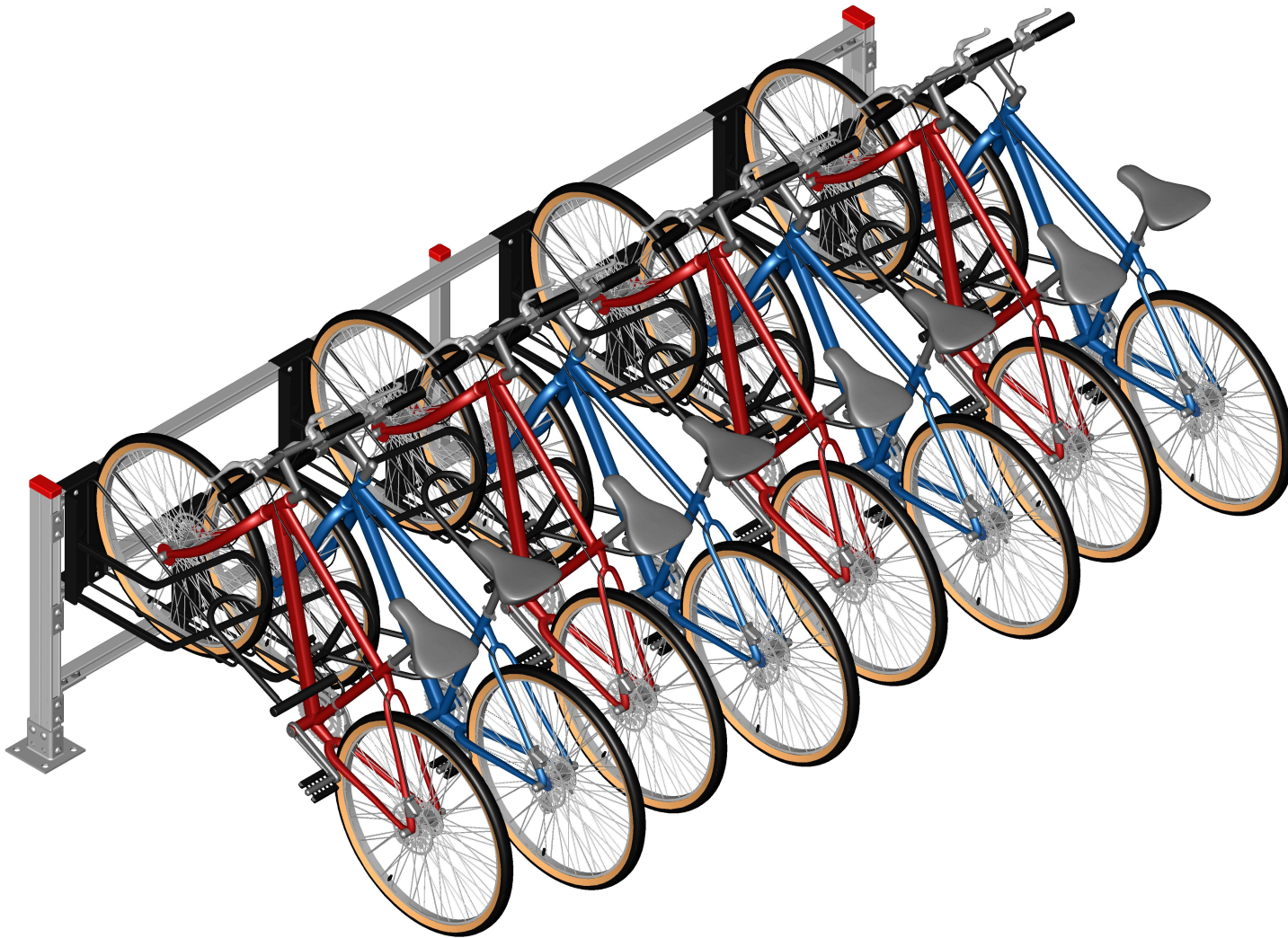

Bike Stall {8-Bike} U-Strut
Post Base {Straight} Master {Iso}

Part #17478

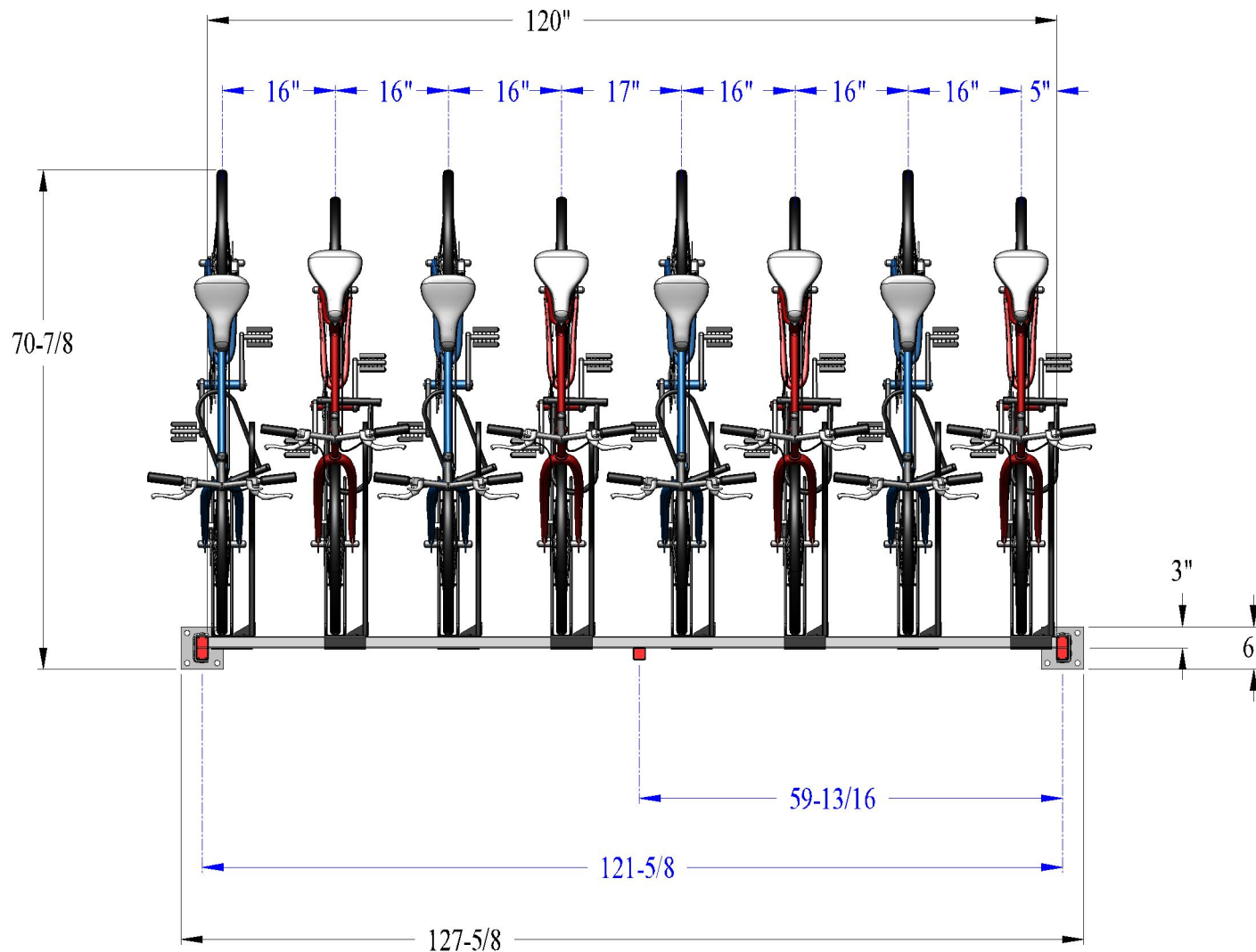

Bike Stall {8-Bike} U-Strut
Post Base {Straight} Master {Top} Dim's

Part #17478

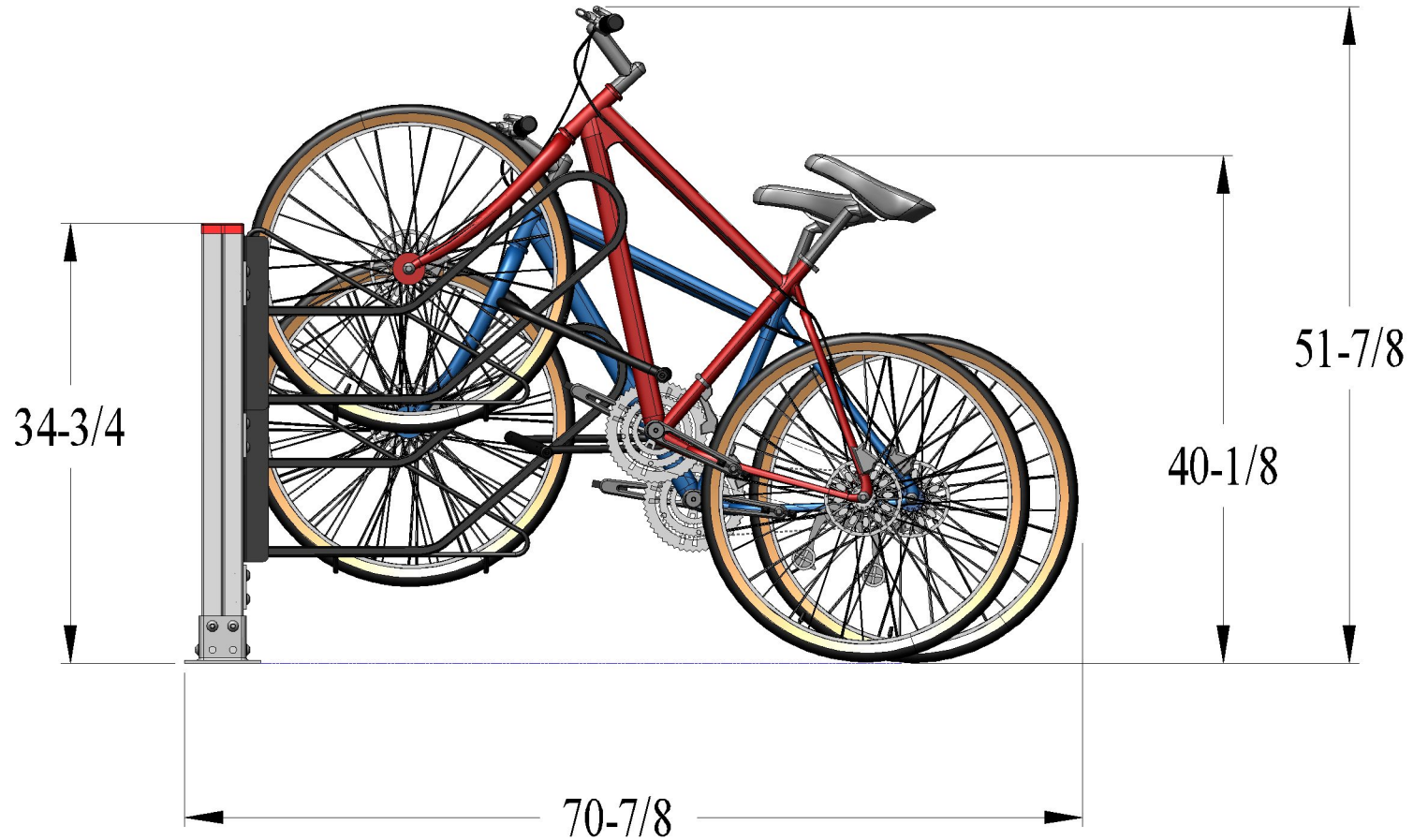

Bike Stall {8-Bike} U-Strut
Post Base {Straight} Master {Side} Dim's

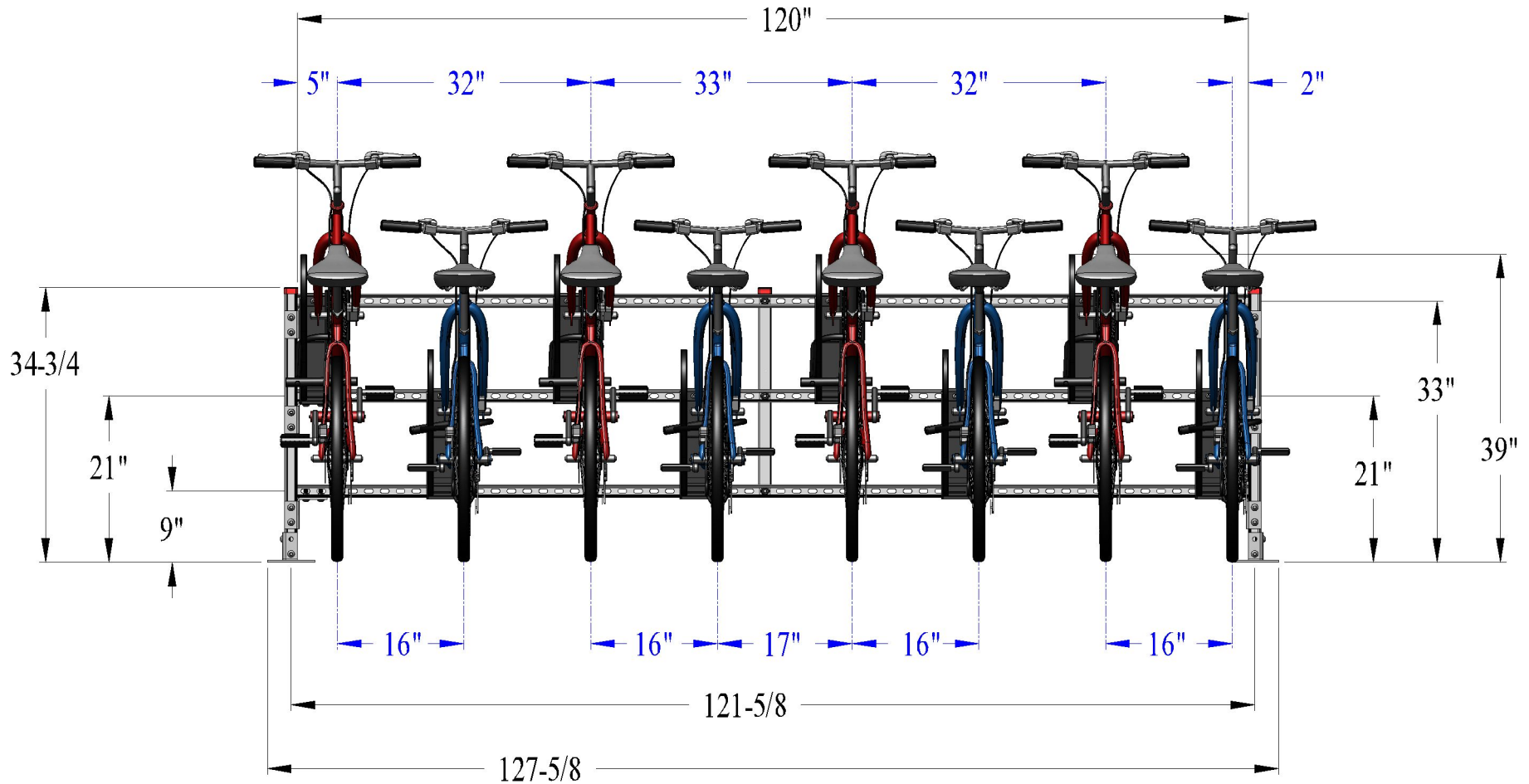

Bike Stall {8-Bike} U-Strut
Post Base {Straight} Master {Front} Dim's

Part #17478

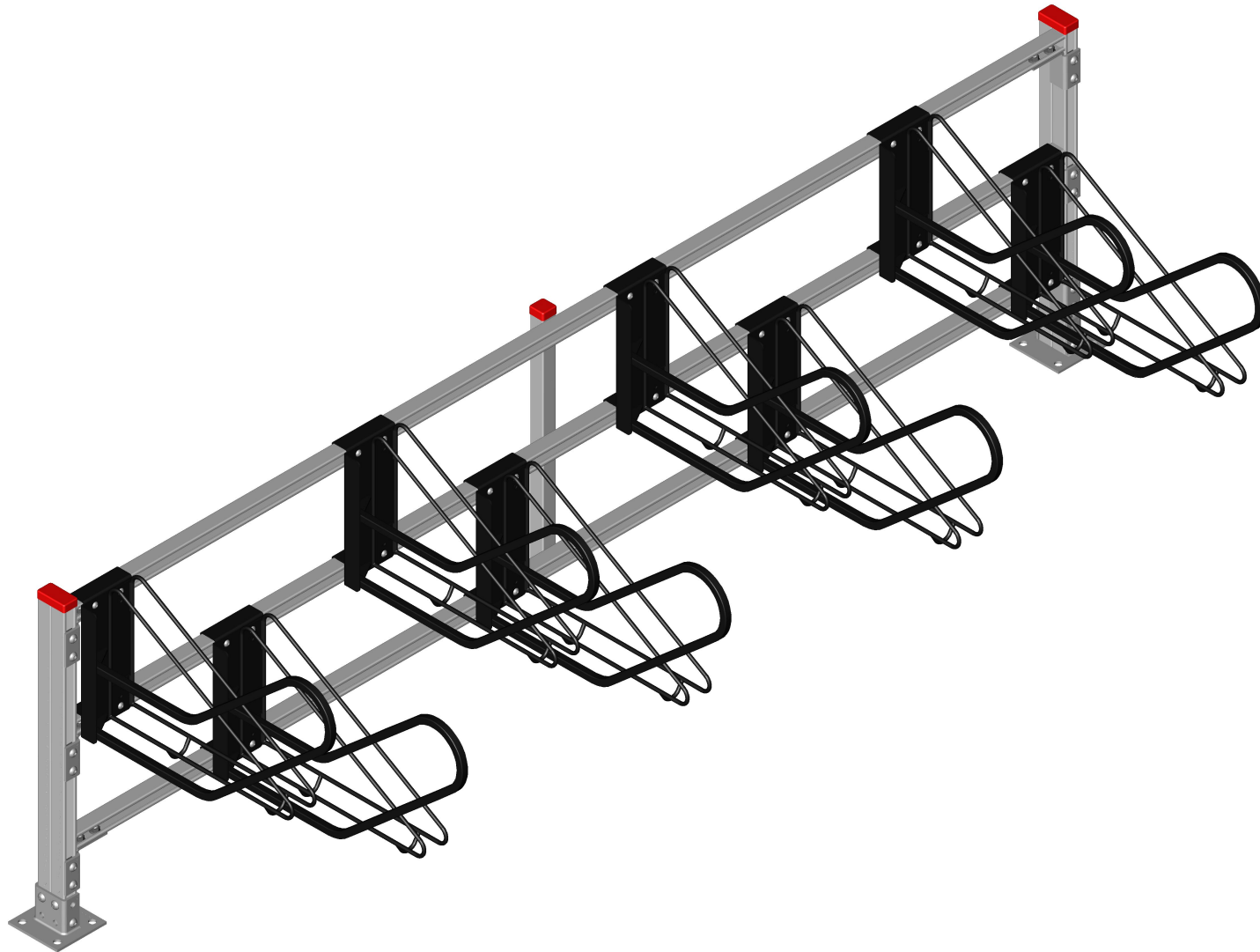

Bike Stall {8-Bike} U-Strut
Post Base {Straight} Assembly {Iso}

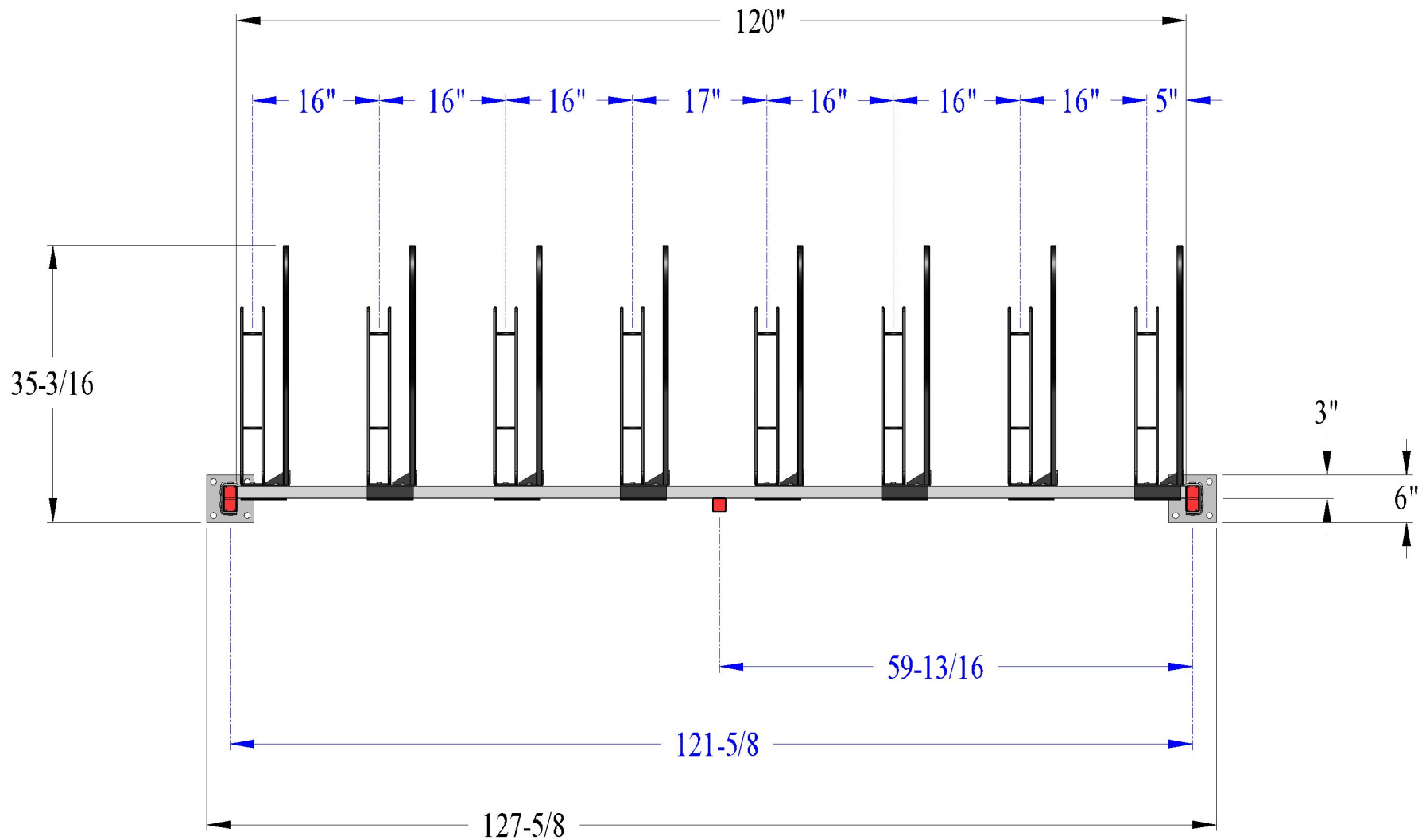

Bike Stall {8-Bike} U-Strut
Post Base {Straight} Assembly {Top} Dim's

Part #17478

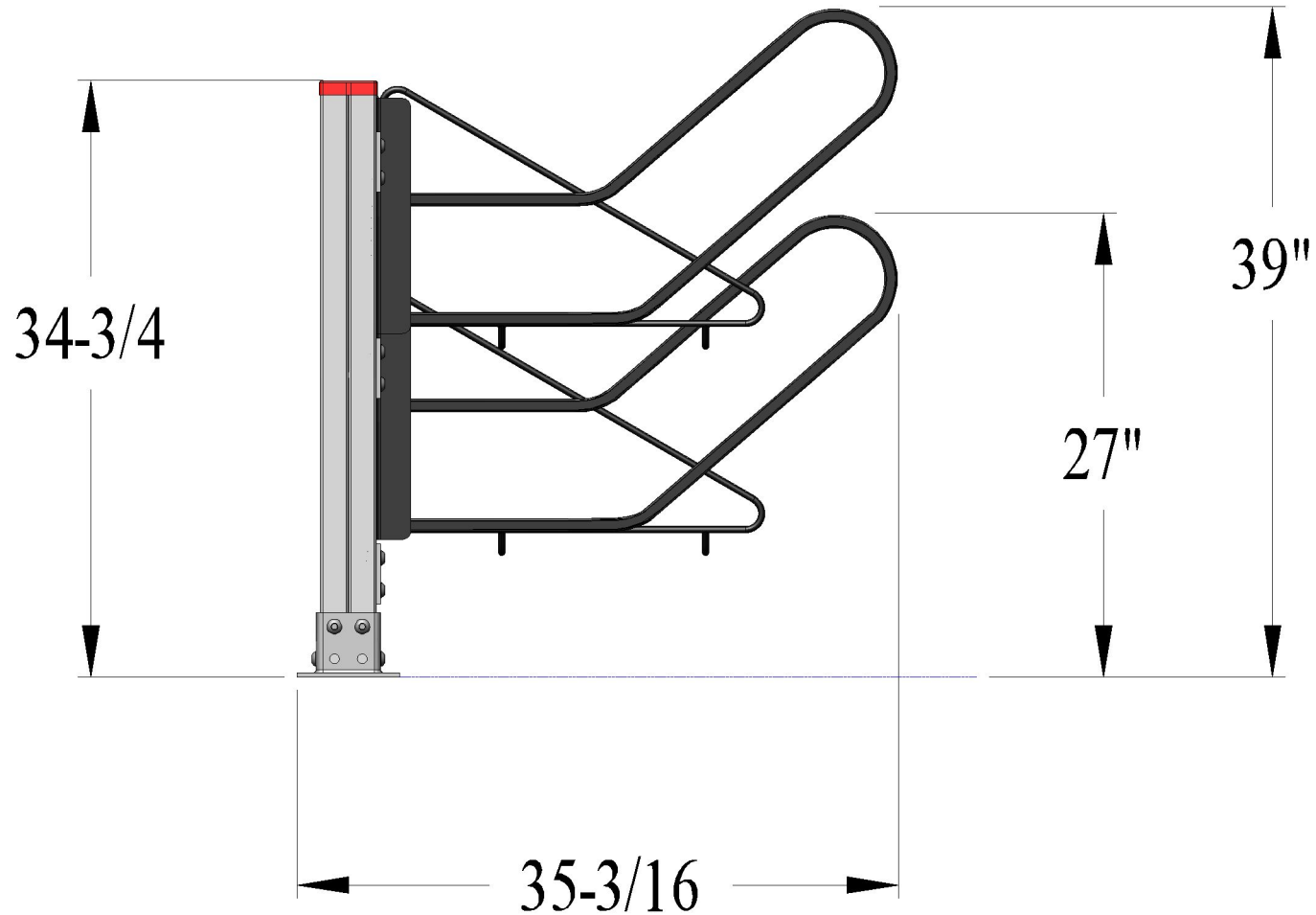

Bike Stall {8-Bike} U-Strut
Post Base {Straight} Assembly {Side} Dim's

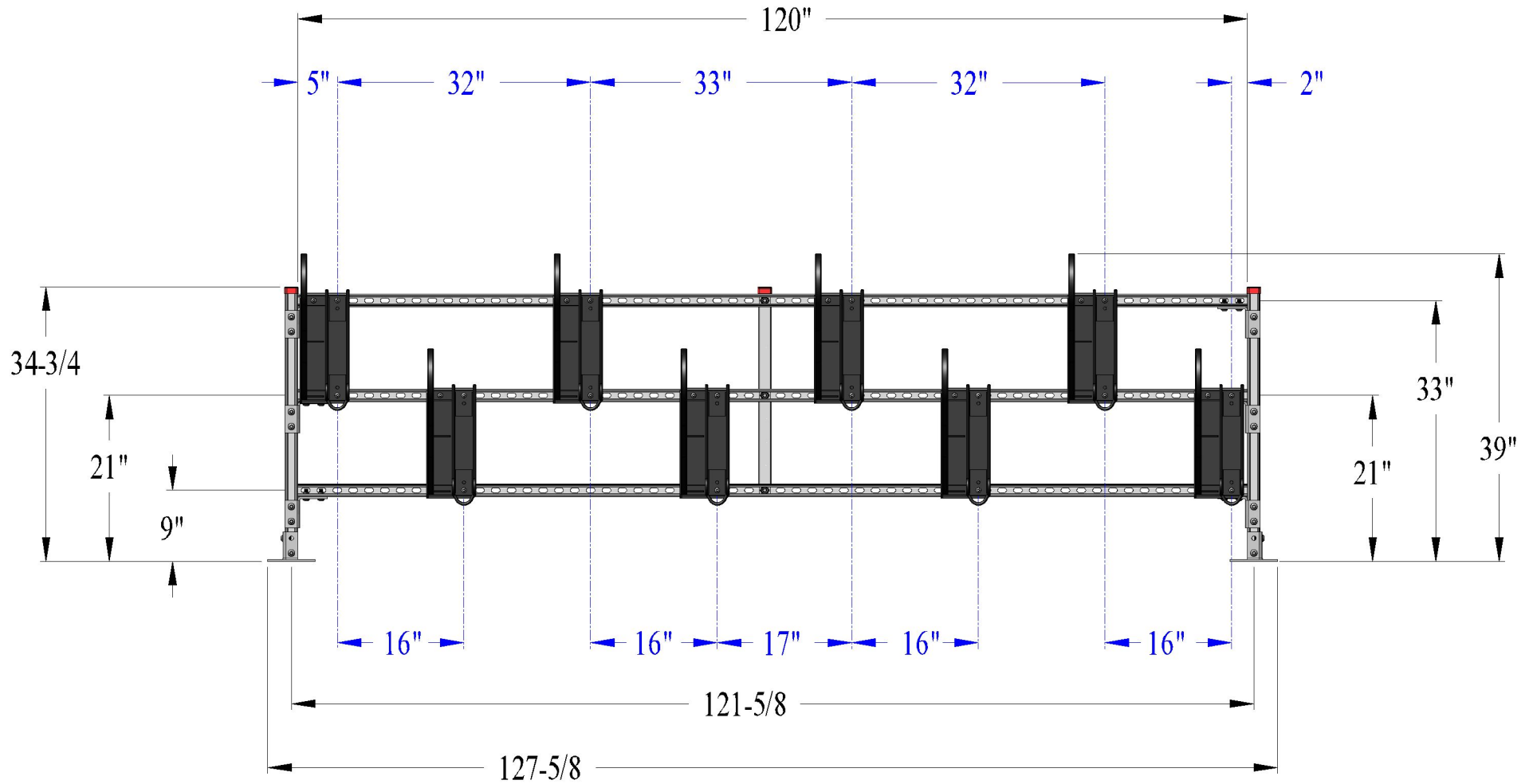

Bike Stall {8-Bike} U-Strut
Post Base {Straight} Assembly {Front} Dim's

Part #17478

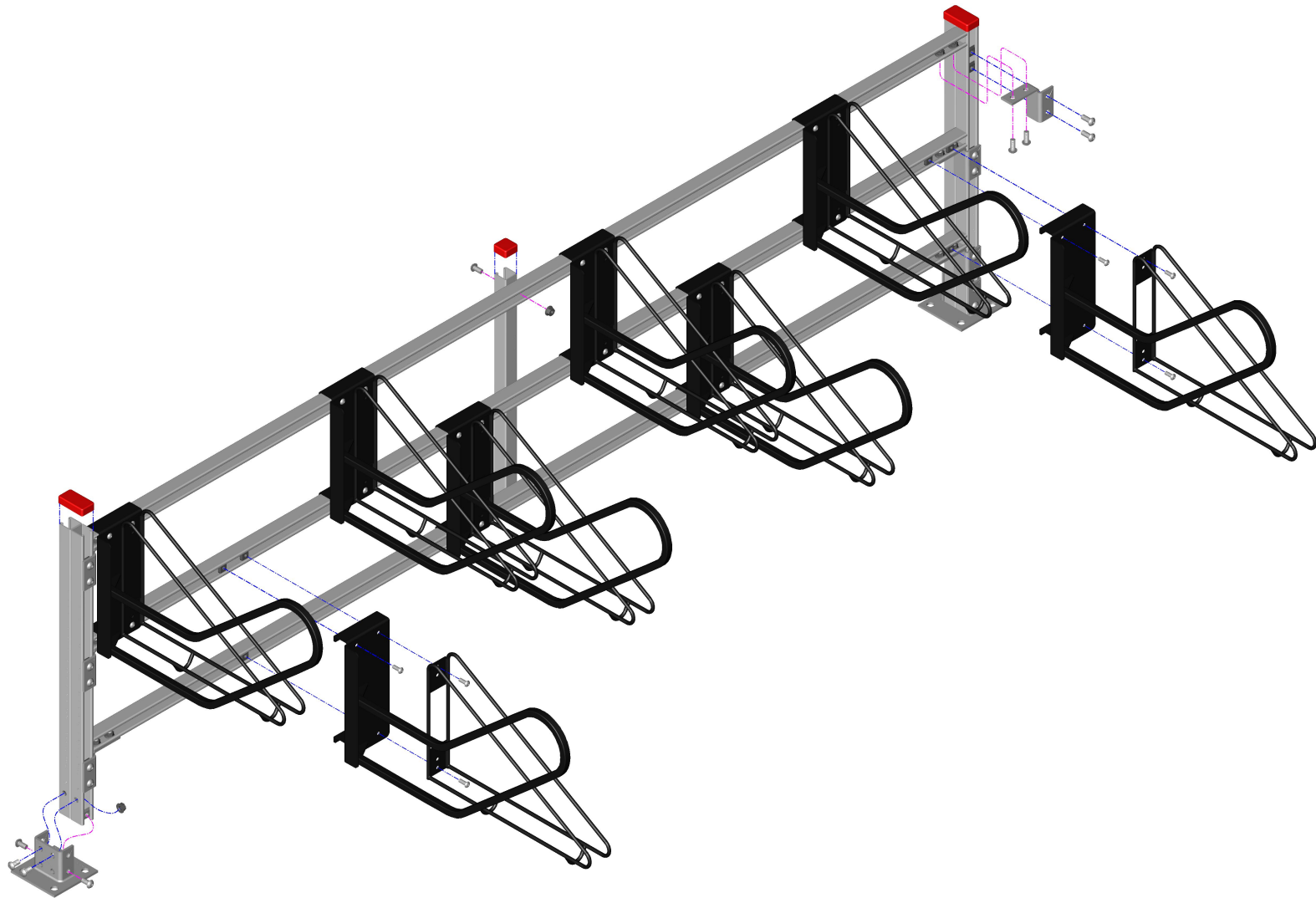

Bike Stall {8-Bike} U-Strut
Post Base {Straight} Assembly {Exploded}

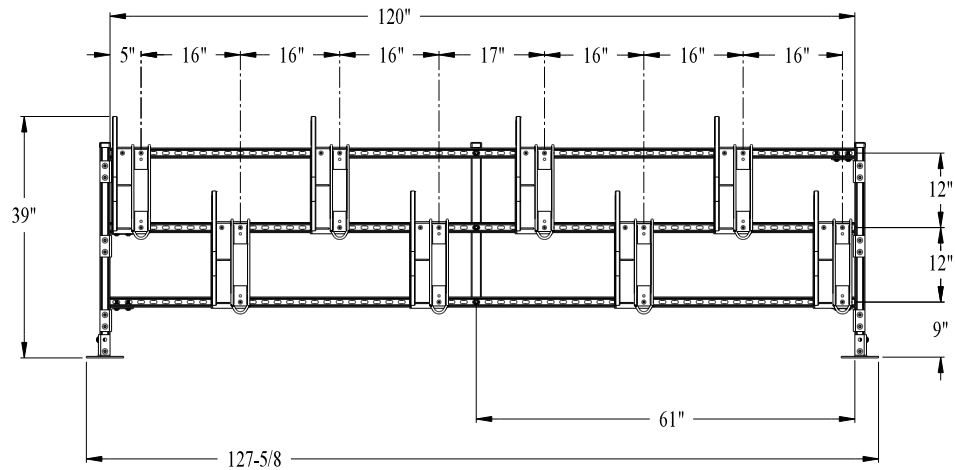
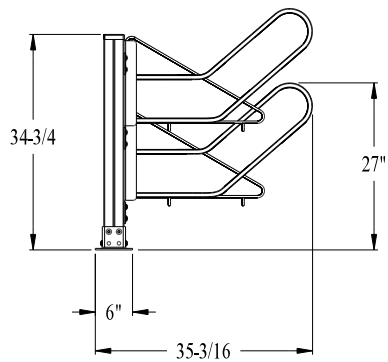

ITEM	QTY	DESCRIPTION	PART NO.
1	3	U-STRUT {SLOTTED} SPANNER x 120" LG.	17470
2	19	3/8-16NC SERRATED FLANGE NUT {ZINC}	19567
3	1	U-STRUT {PLASTIC} END CAP	17530
4	2	H-STRUT {PLASTIC} END CAP	17551
5	2	H-STRUT {PLAIN} UPRIGHT x 34-3/8" LG.	17570
6	40	3/8-16NC STRUT {ZINC} NUT	17525
7	3	LARGE - WING FITTING {LEFT}	17474
8	3	LARGE - WING FITTING {RIGHT}	17475
9	2	H-STRUT {POST} BASE	17485
10	59	3/8-16NC x 1" LG. {TORX} S/S BHCS	12724
11	8	POWDER COATED {BLACK} WALL-RACK	17502
12	8	LOCK BAR WELDMENT	17549
13	1	U-STRUT {PLAIN} VERTICAL x 26-1/4" LG.	17471

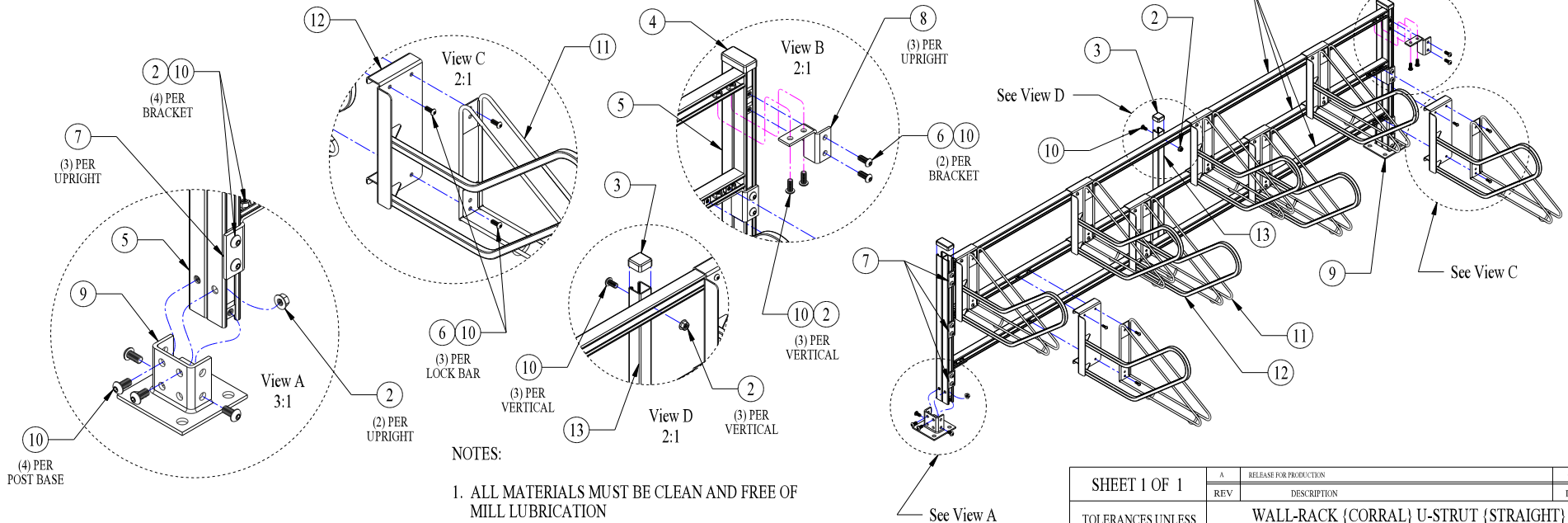

NOTES:

1. ALL MATERIALS MUST BE CLEAN AND FREE OF MILL LUBRICATION
2. ANY BLEMISHES OR RUST WILL NOT BE ALLOWED ON COMPLETED PRODUCTS
3. FOR "TAMPERPROOF" FASTENERS: USE 3/8 S/S TORX {PINNED} BHCS (17590) IN PLACE OF ITEM #10

**SINGLE-SIDED
HIGH DENSITY**

SHEET 1 OF 1		A	RELEASE FOR PRODUCTION	01/21/14
REV	DESCRIPTION	REV	DATE	DATE
TOLERANCES UNLESS OTHERWISE SPECIFIED: +/-		WALL-RACK {CORRAL} U-STRUT {STRAIGHT}		
.X	.030	Cycle Safe 5211 CASCADE RD SE, SUITE 210 GRAND RAPIDS, MI 49546 www.cycleSAFE.com		
.XX	.010			
.XXX	.005			
ANGLE	1/2°	BOB SLYH	01/21/14	
		CHECKED	DATE	
		APPROVED	DATE	
REV D	POST BASE {8-BIKE} ASSEMBLY			17478
		REV A		